

CASE STUDY



+ Data centre

BAYER CROPSCIENCE
Mumbai, INDIA.





Entrance lobby



Office area



Brief:

Bayer CropScience is one of the world's leading innovative cropscience companies, in the area of crop protection, non agricultural pest – control, seeds and plant biotechnology. Headquartered in Monheim, Germany, Bayer CropScience has a global workforce of about 17,900 and is represented in more than 120 countries. In it's quest to excel and expand Bayer proposed to set up and office space in Mumbai.

Location:

Powai, Mumbai.

Area :

80,000 sq.ft.

Concept:

The concept was to communicate Bayer's business activity, by initiating the design process and then evincing the essential requisites. Transparent spaces and glazed atrium gave way to natural light, making the place look bright & elegant.

BAYER CROSCIENCE

Mumbai, INDIA.



Md's office

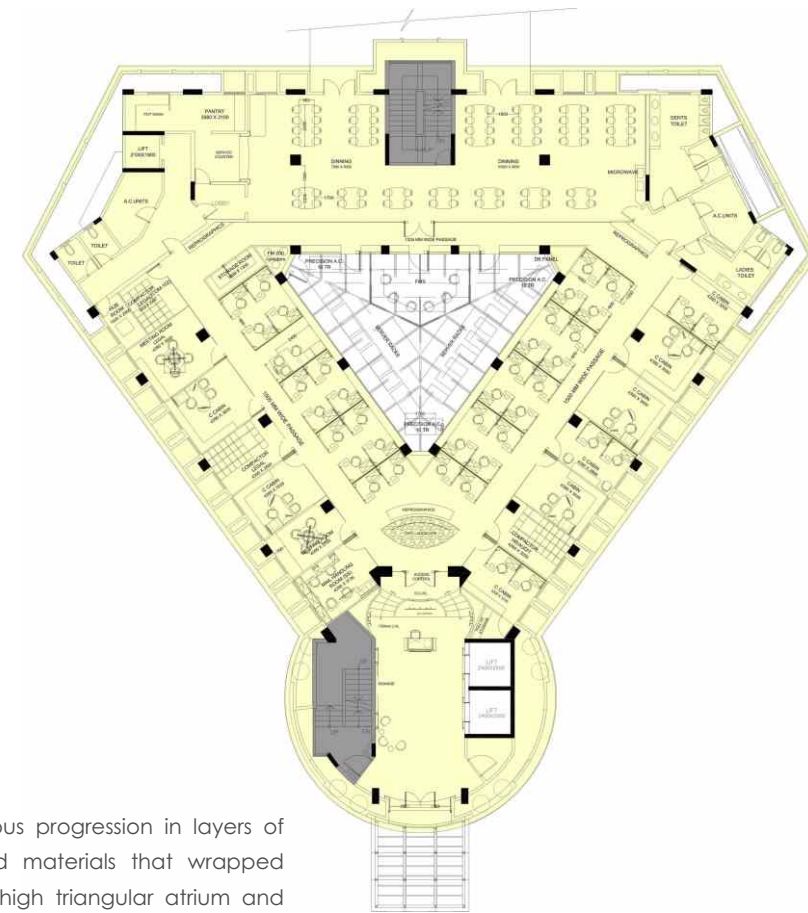

1ST FLOOR PLAN

Bayer's Outlook:

Bayer wanted an office with a unique character; functional, yet open to contemporary & in tune with its own identity.

Challenge:

Being largely a 'paper-less' office, the design had to include an intentional dearth of storage. The foremost priority was to maintain the highest standards in the aspect of HSEQ (Health and Safety, Environmental Protection and Quality Assurance). Design had to address reduction in energy costs which was a result at existing base-build.

Execution approach:

The design developed as a porous progression in layers of transparency with aptly selected materials that wrapped around the central six – floored high triangular atrium and spliced through the stepped floor around. This allowed the natural light to penetrate in the office areas and allow a through and through view across all levels.

Uniqueness of the design:

Uniqueness lies in the spaces, with abundant light and without hierarchical delineations, where people share that comfort factor of being able to see each other and forming spaces that encourage interaction, but not at the cost of work.